

INSTALLATION MANUAL

For the most current release of this manual,
please visit our website at cogan.com

V.2015.1

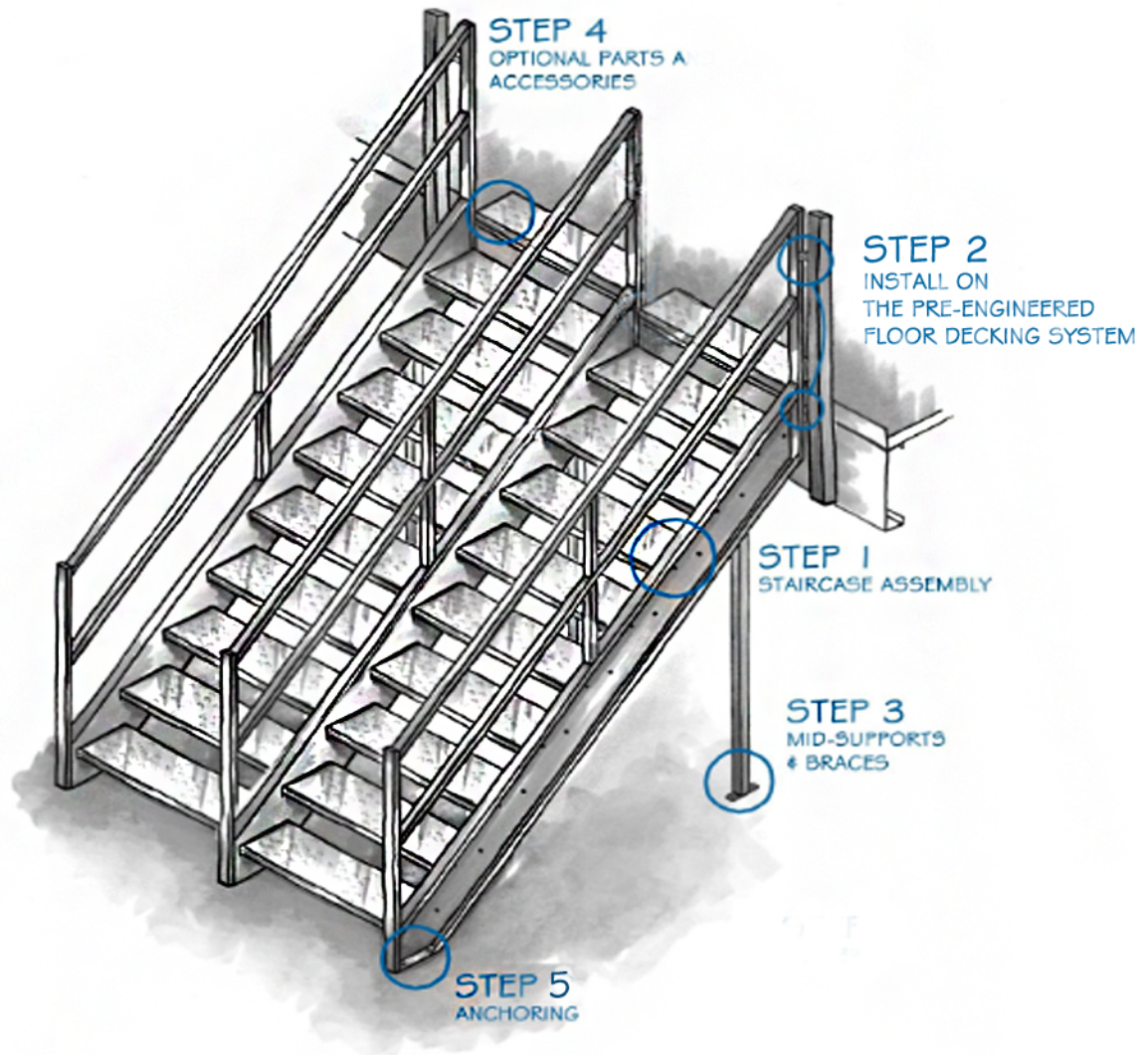

Product	Pre-Engineered Floor Decking System
Sub-product	Double Staircase
<ul style="list-style-type: none">- 3 Models of double staircase available : 2 rail, 3 rail, wire mesh panels- Handrail is factory welded to the stringer- Steps are bolted to the stringer	



Cogan®

A Tradition of Quality Since 1901

cogan.com

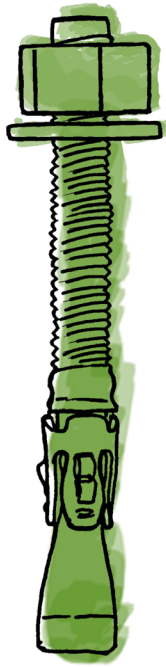

Ø3/8" x 2 3/4" BOLT
(ANCHOR)



Ø1/4" x 1" FLAT
HEAD TEK SCREW

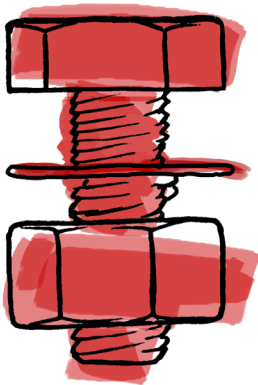

Ø3/8" x 1" BOLT

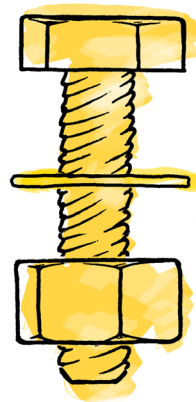

Ø3/8" x 1 3/4" BOLT

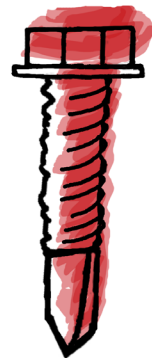

Ø1/4" x 1" HEX
HEAD TEK SCREW

3 MODELS ARE AVAILABLE

2 RAILS
38° angle

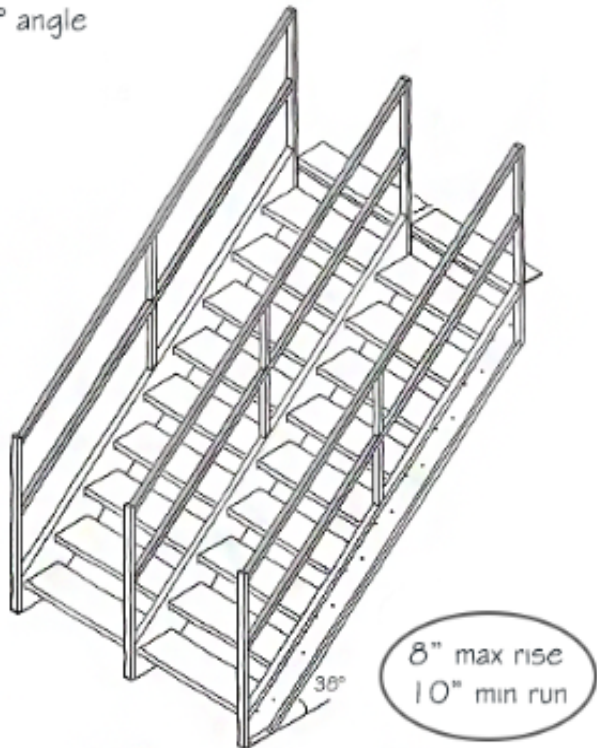

3 RAILS
31° angle

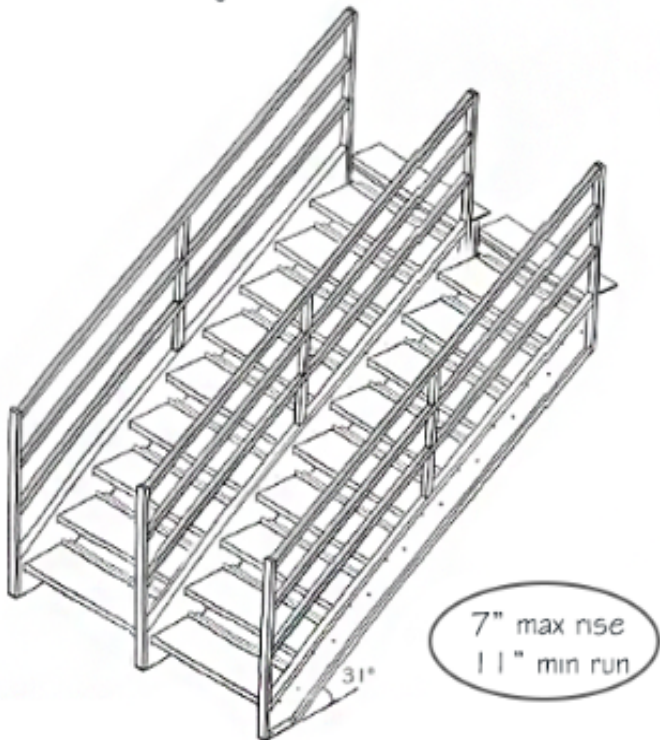

2 RAILS
WIRE MESH PANELS
31° angle

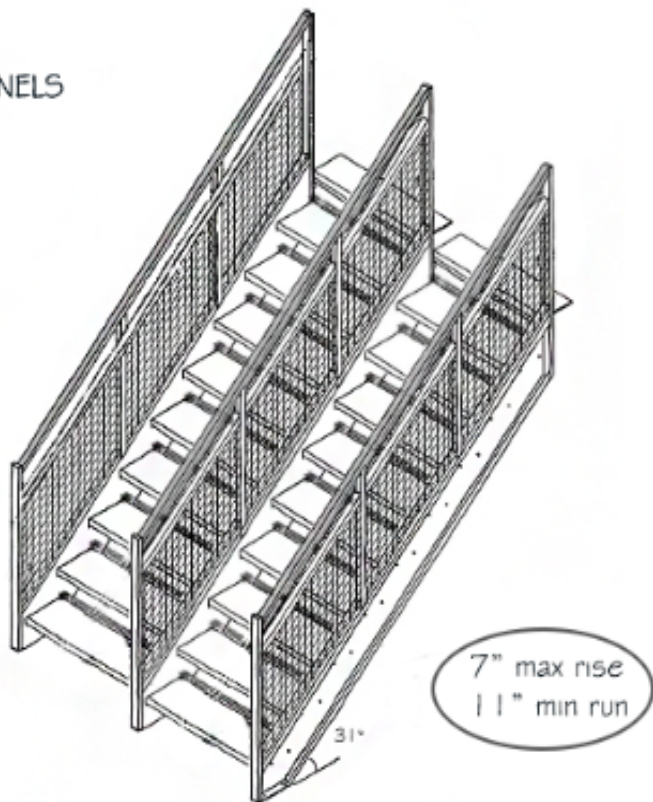

STEP 1

ASSEMBLING STEPS WITH STRINGERS

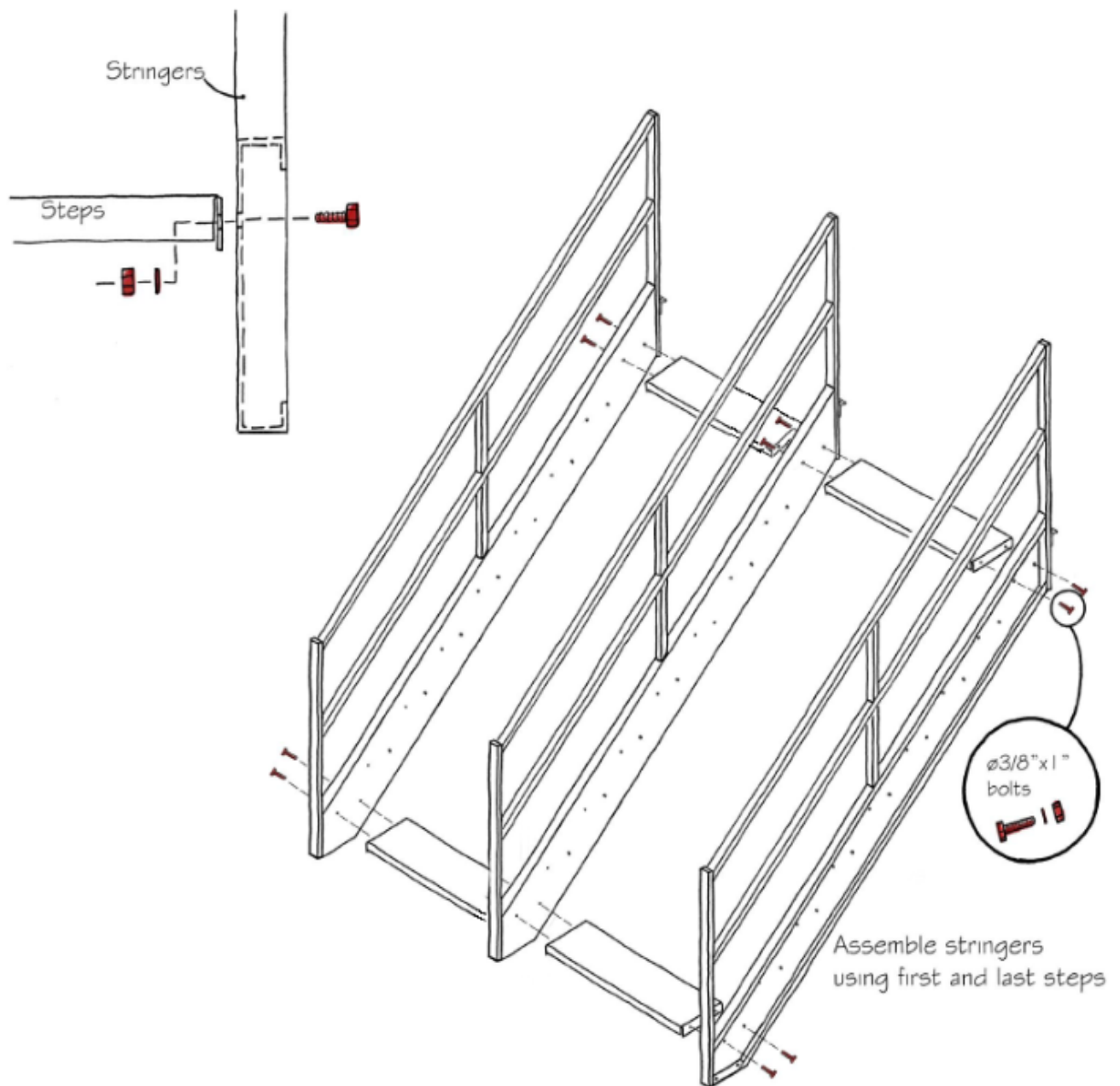

STEP 2

ATTACH STAIRCASE TO PRE-ENGINEERED FLOOR DECKING SYSTEM USING

"L" BRACKET AND ANGLE.

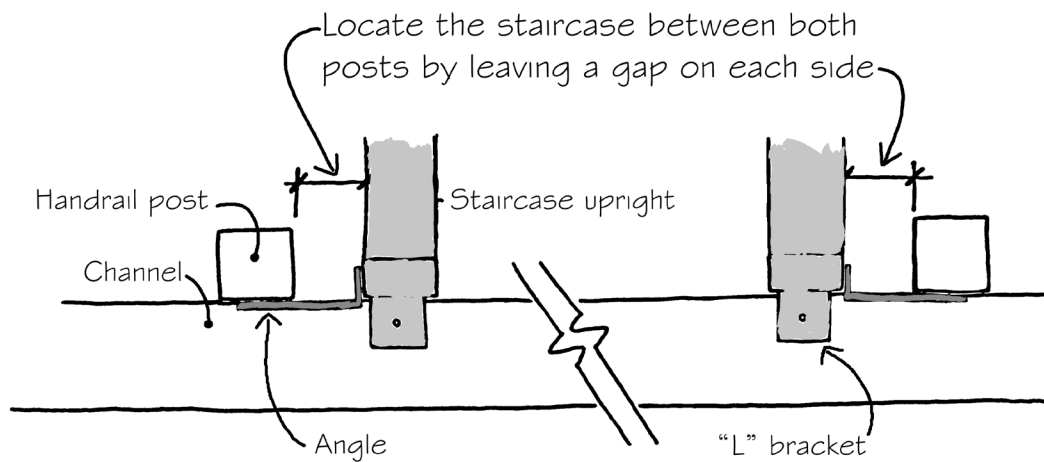
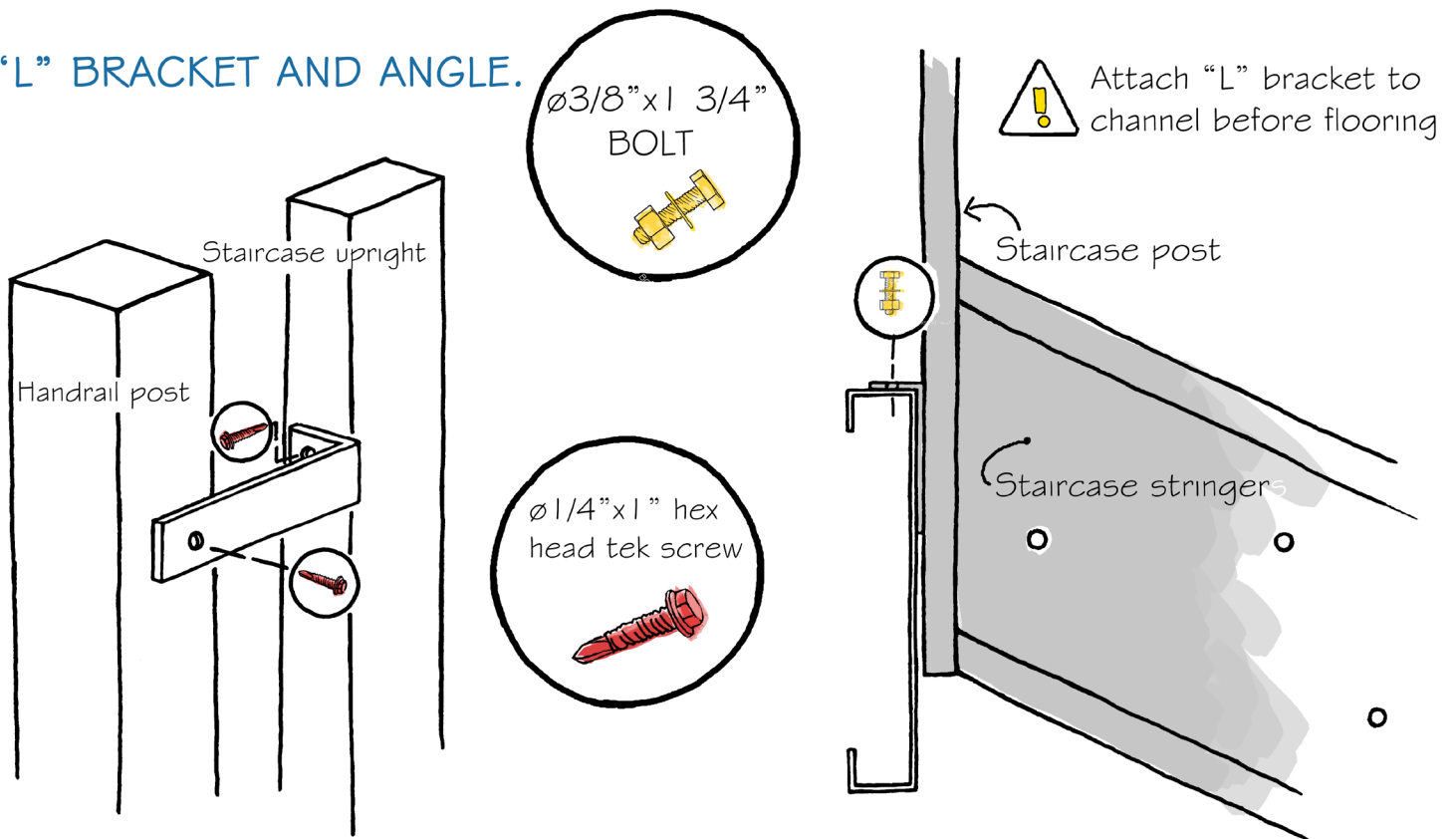

STEP 3

MID-SUPPORTS

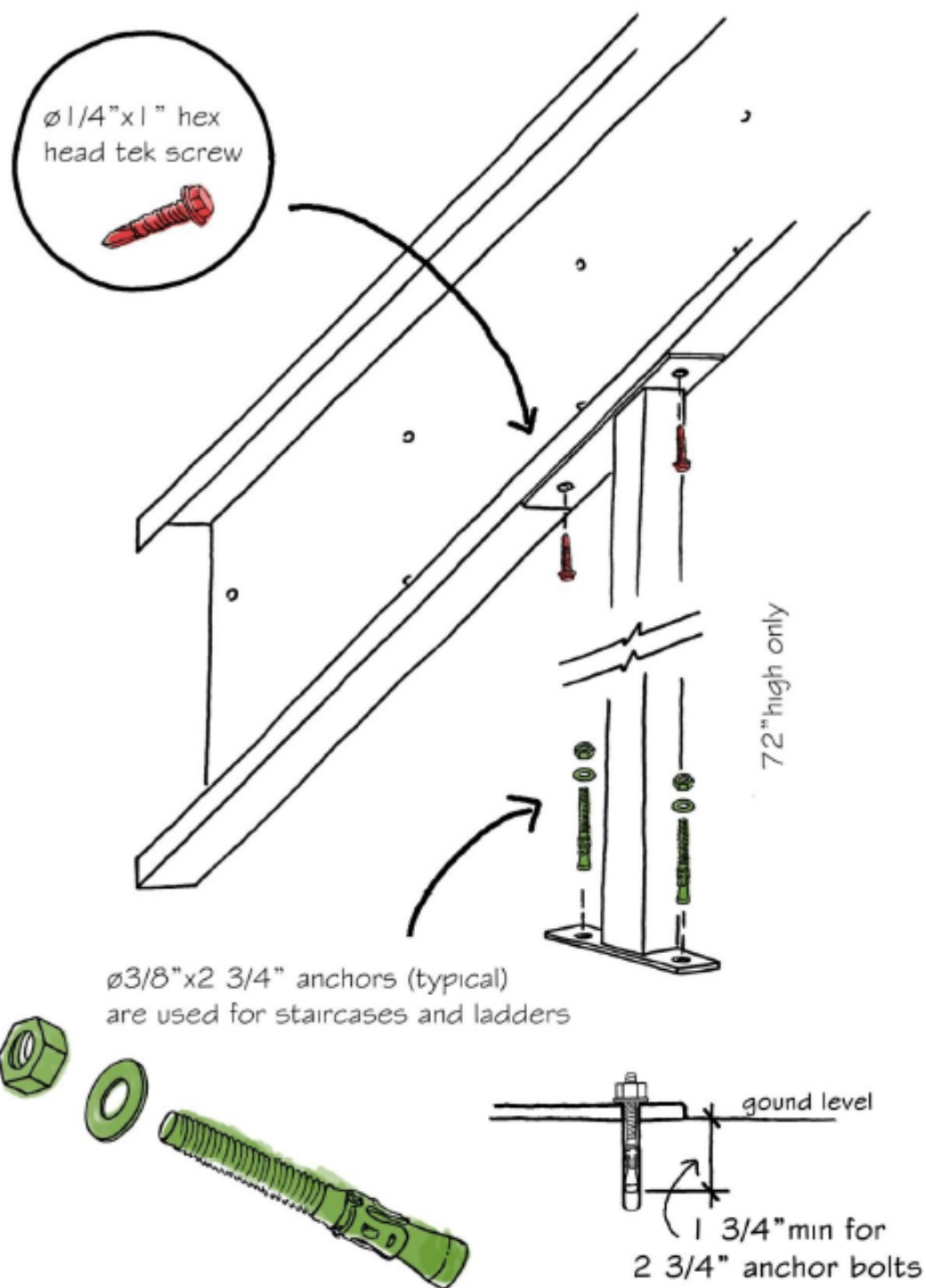

MID-SUPPORTS ARE USED ON STAIRCASES 8' HIGH OR GREATER

SEE STEP 6 FOR COMPLETE DETAILS ON ANCHORING

STAIRCASE BRACES

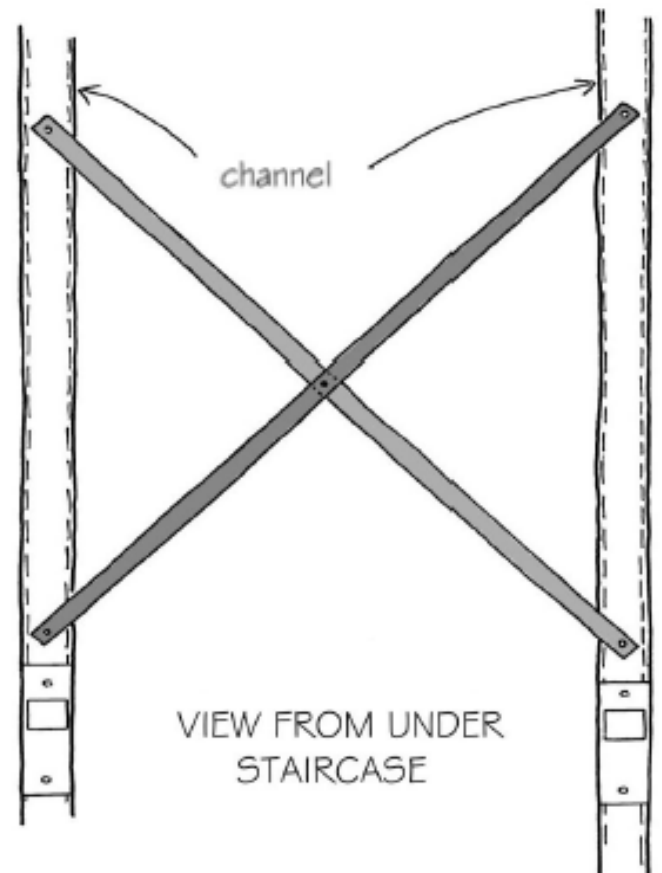

Ø1/4"x1" hex
head tek screw

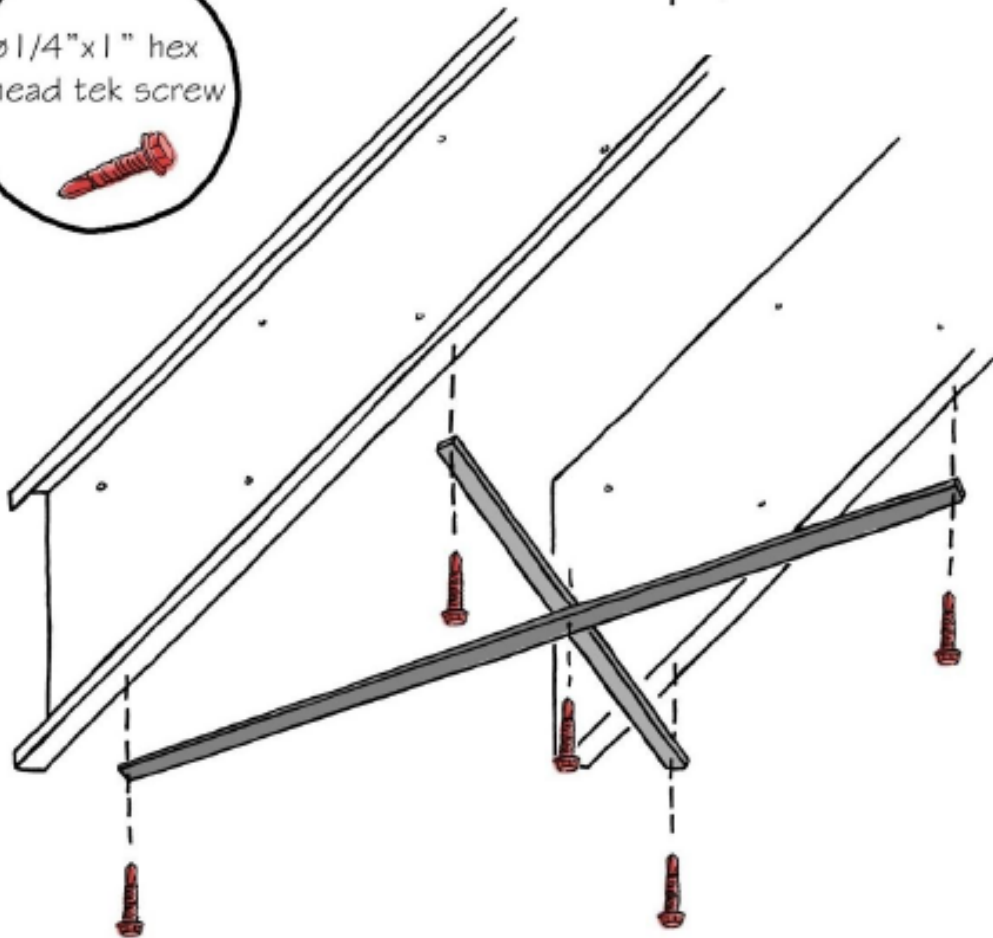

MID-SUPPORT BRACES

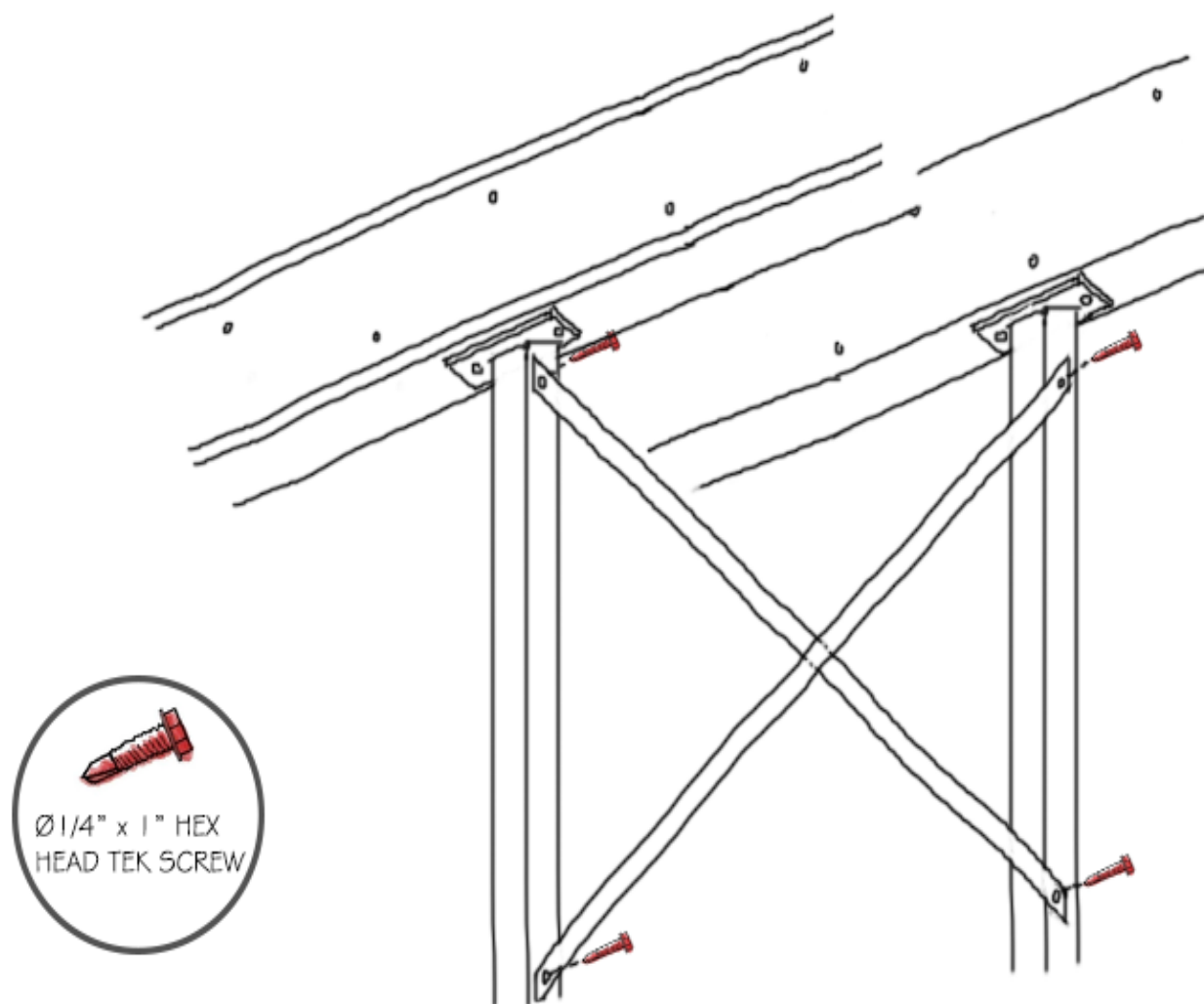

BRACES ARE INSTALLED BETWEEN MID-SUPPORT

STEP 4

OPTIONAL PARTS AND ACCESSORIES (CLOSED RISER FOR 31° STAIRCASES)

Fasten closed riser to front lip of each step

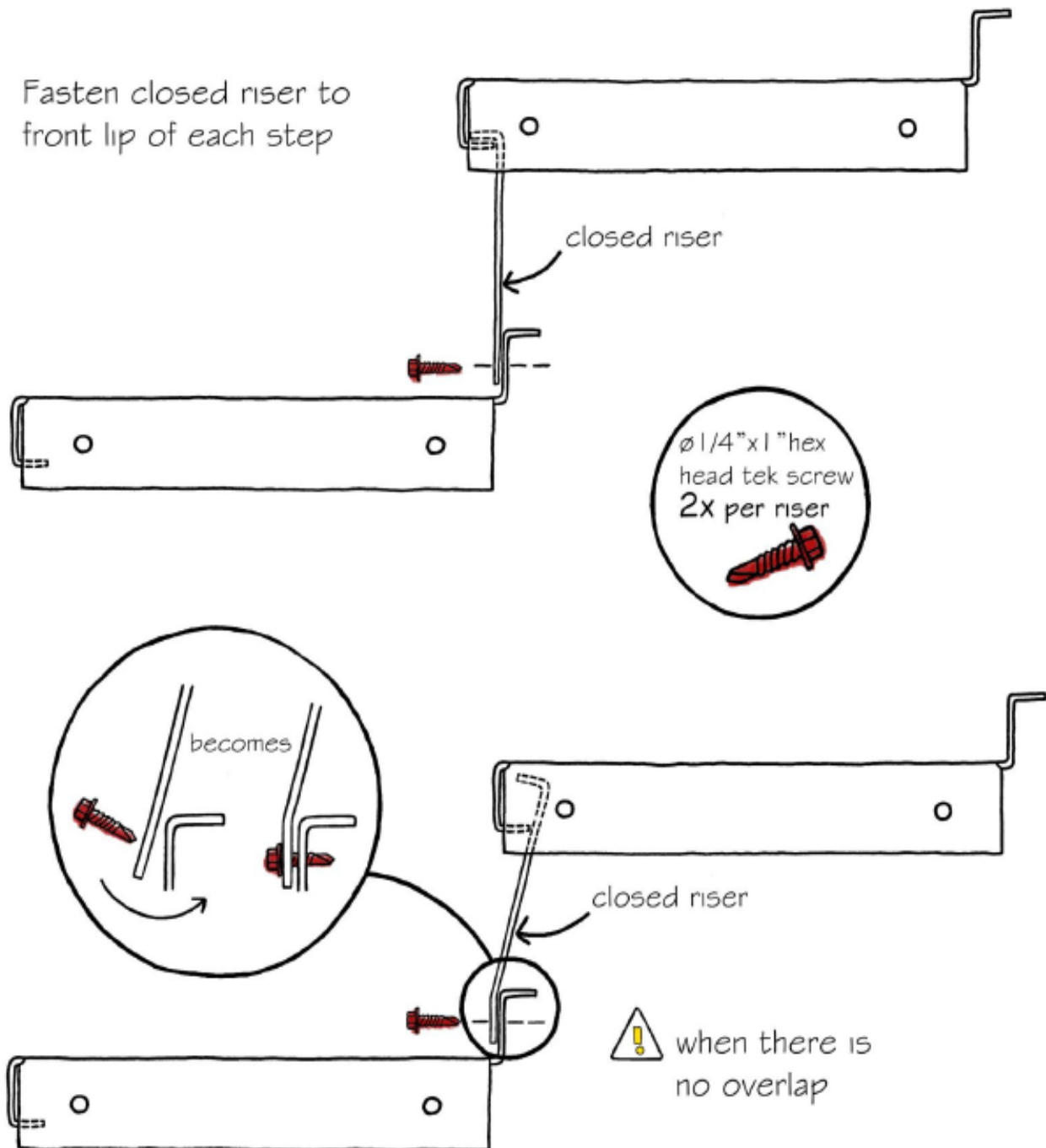

OPTIONAL PARTS AND ACCESSORIES (CLOSED RISER FOR 38° STAIRCASES)

Fasten closed riser to
back of each step and
to bent edge of riser above

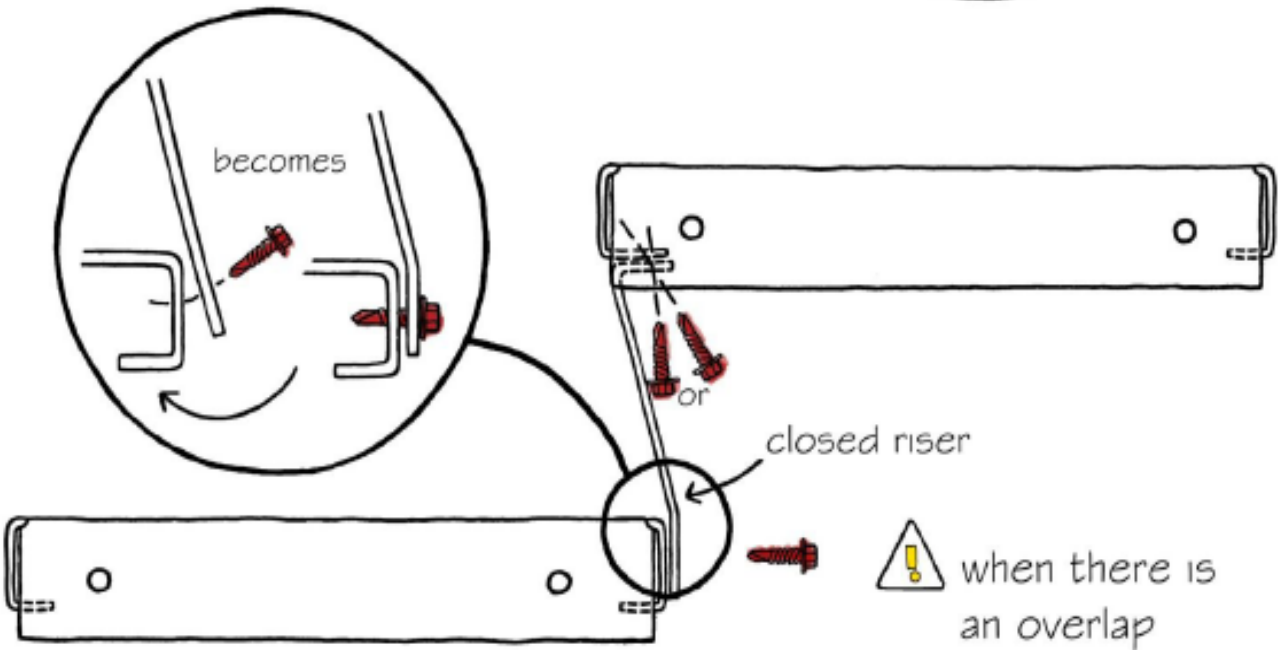
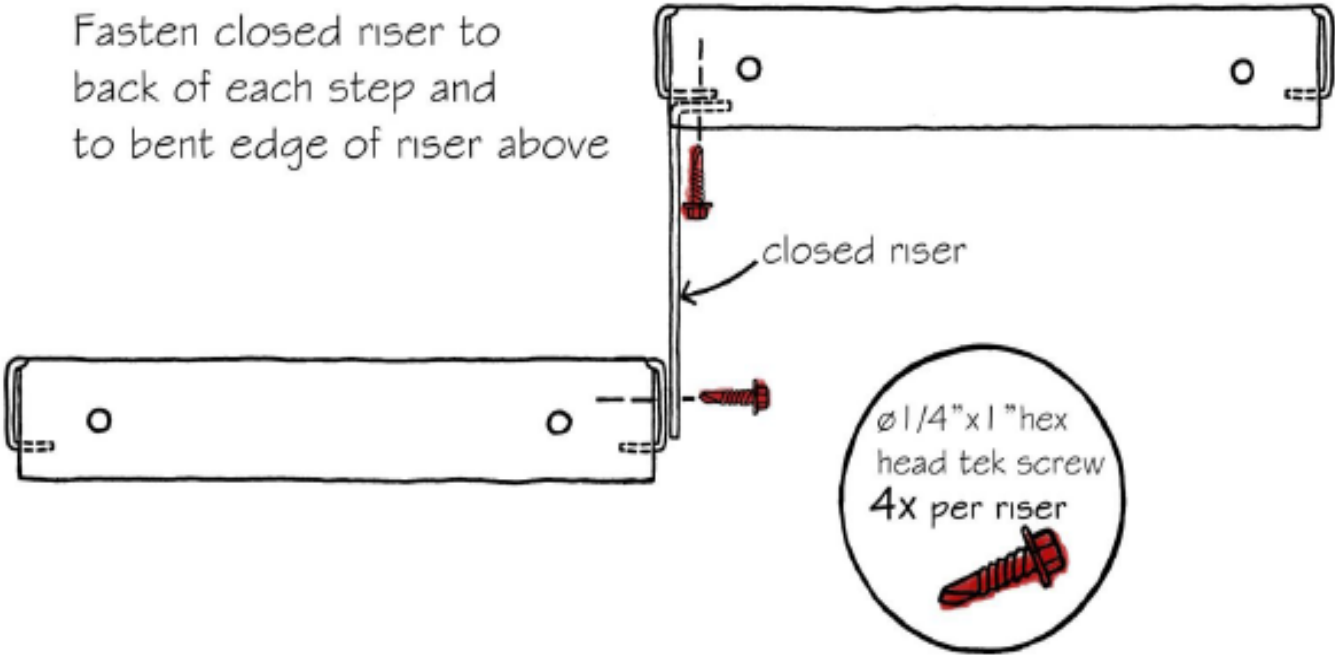

OPTIONAL PARTS AND ACCESSORIES (NOSING)

After flooring is in place, install nosing

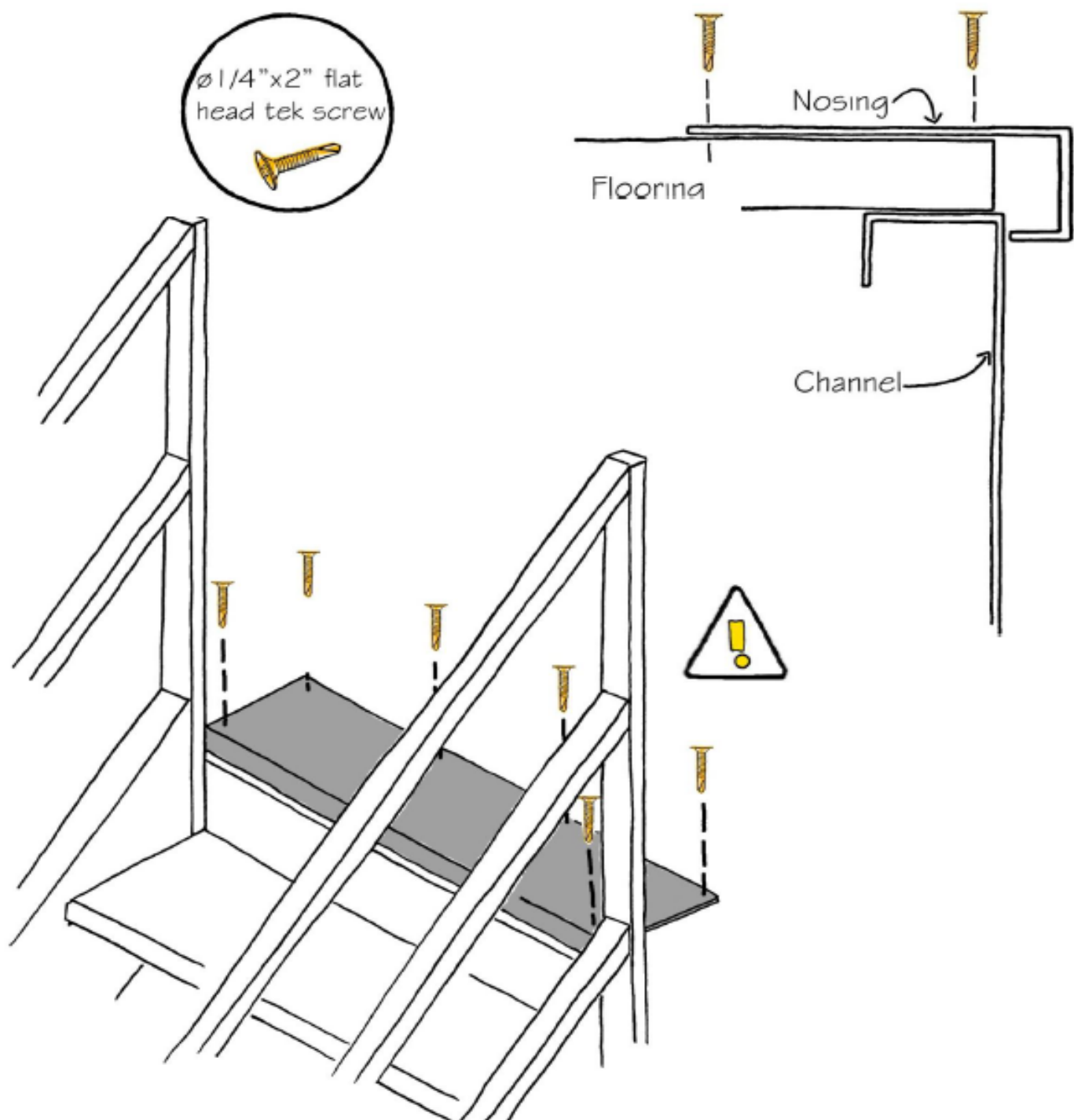

STEP 5 (A)

ANCHORING STAIRCASE

(If staircase sits on a concrete surface, follow these instructions)

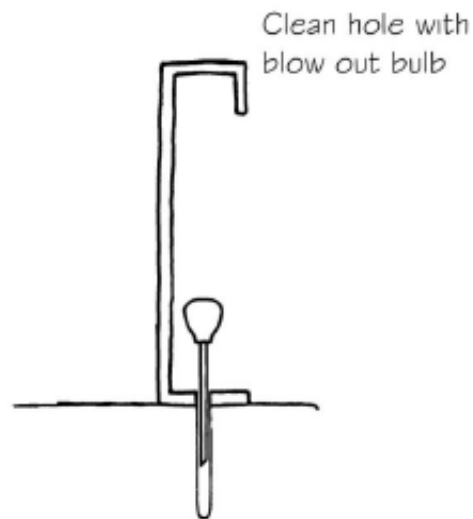
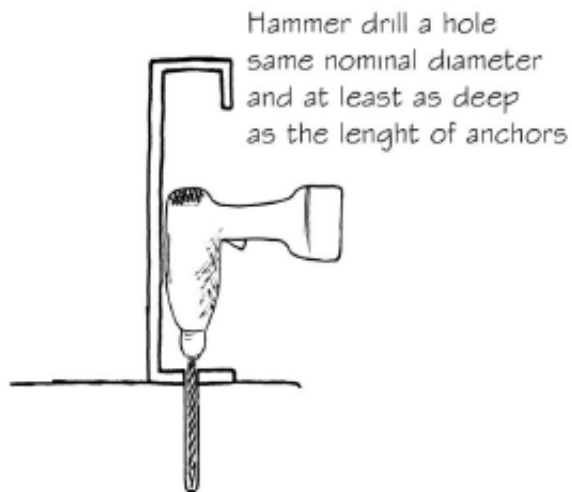

Drive the Hilti bolt so that at least
6 threads are below top surface of
fixture.

Tighten to recommended
torque value to achieve proper
anchor setting

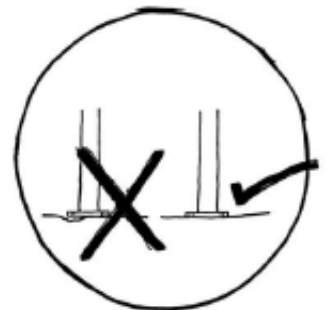
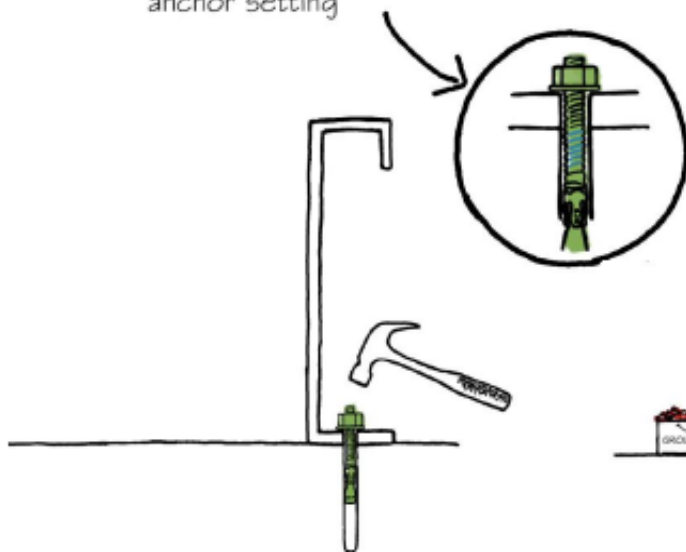
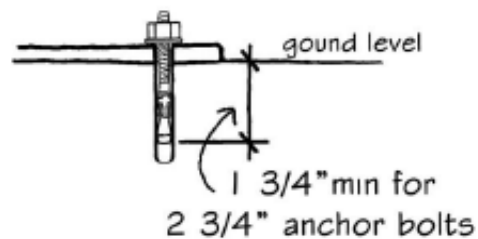

STEP 5 (B)

ANCHORING STAIRCASE

(If staircase sits on the Pre-Engineered Floor Decking System, follow these instructions)

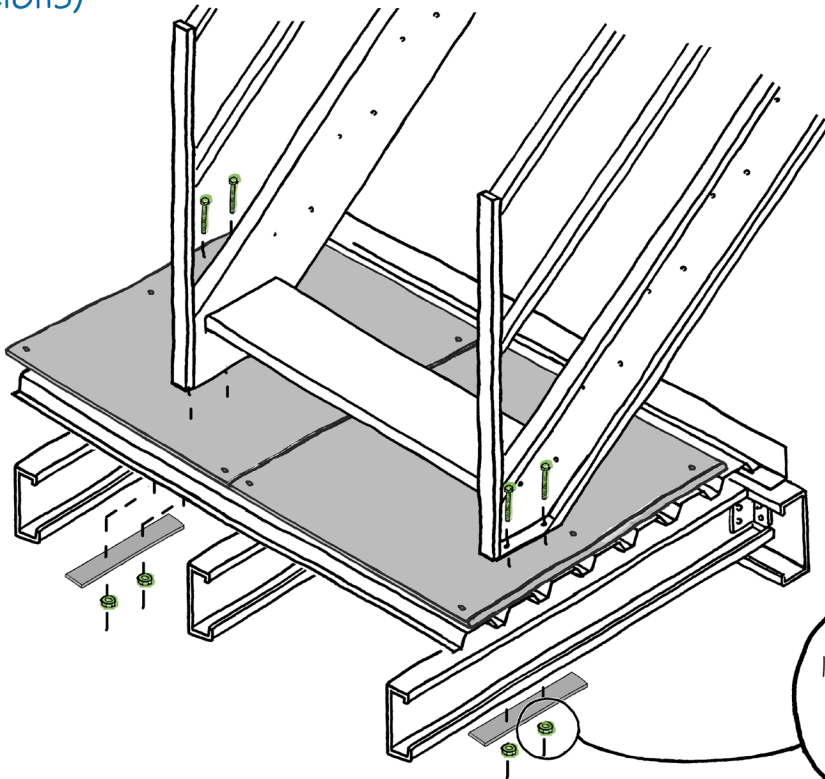

ON STEEL DECK SURFACE

Bolt sandwich plate under the steel deck to help secure the staircase in place.

Always lay sandwich plate perpendicular to the steel deck orientation.

Ø 3/8" x 3
1/2" structural
bolts

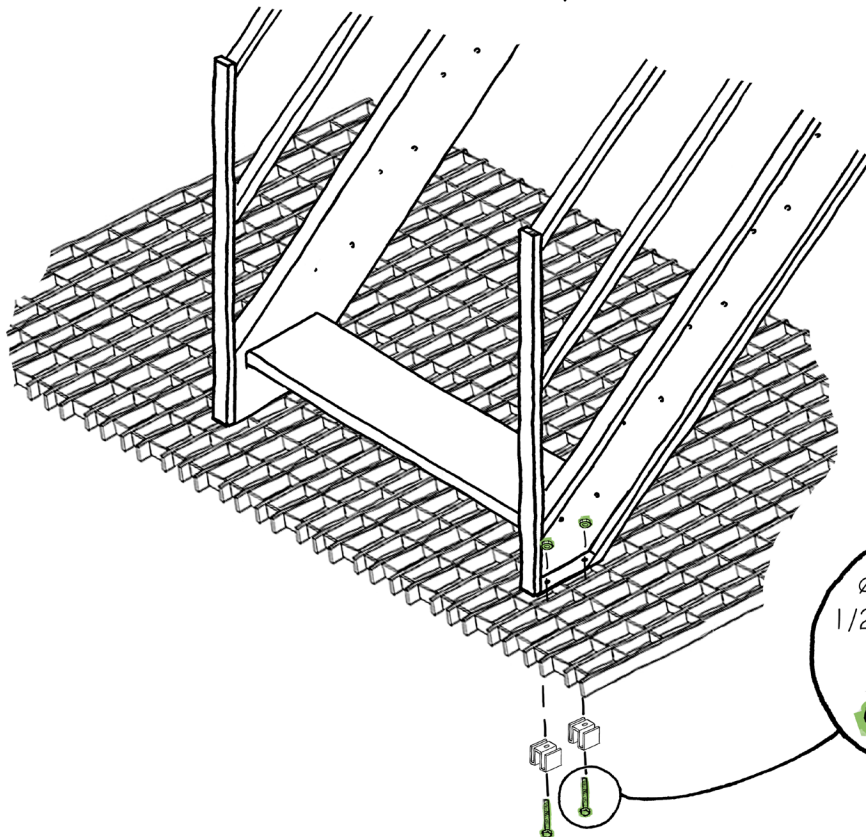

ON BAR GRATING SURFACE

Invert clips and bolt to the staircase base plate to secure it from under. Put one structural bolt in each hole of the staircase base plate.

Ø 3/8" x 3
1/2" structural
bolts

